

Give Us Your Views

Visitors' Centre

A Visitors' Centre has been set up at the top of Beach Road. This provides an opportunity to view the works safely, to learn more about the history of Cleveleys and show the requirements for the Coastal Defence works. Please feel free to leave any comments you have in the visitors' book.



Visitors' Centre

Website

Please visit our Cleveleys website which is accessible via the council's website at www.wyrebc.gov.uk. Click on the icon shown below to enter the Cleveleys site.



The council will continue to provide information through exhibitions and newsletters as the scheme progresses. We would welcome any comments or questions you may have on the scheme. Our contact details are as follows:

Email: cgreen@wyrebc.gov.uk Tel: 01253 887215

Address: Mr Carl Green, Coastal and General Engineering Section, Engineering Services, Wyre Borough Council, Breck Road, Poulton-le-Fylde, Lancashire FY6 7PU

Jubilee Gardens

The first stage of Jubilee Gardens is now open. The skateboard park, playground and multi-use play area are well used. The rest of the park is planned to open in August once the grass is established. A new memorial has been commissioned and both the original plaque and a new one will be mounted and formally unveiled at an opening ceremony in the autumn.

April 2006 stage of the Jubilee Gardens is opened and playground is in use



New Wave
protecting and investing in Cleveleys

Cleveleys Coastal Defence Improvement and Promenade Enhancement Scheme

Good progress has been made on the sea defence works. High quality and durability has been achieved on the revetment units (concrete steps).

Creating the People's Promenade

This is the third in a series of brochures to provide information on the major construction schemes at Cleveleys seafront. The phase of sea defence works between Carr Gate and Beach Road is now halfway through and progressing well, with an anticipated opening date of December this year.

The scheme has been designed to be robust and of very high quality. The council have put a great deal of effort into testing a variety of materials prior to the start of the works, which has resulted in a high durability and quality finish to the revetment units. This mix of quality and durability will continue in the coming months, which will see the construction of the rear sea wall and the promenade surface.



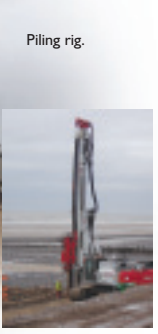

Piling rig.

Construction Process

A variety of construction plant equipment can currently be seen on the beach. We have set up a pre-cast concrete facility at Thornton, which manufactures the 16 tonne concrete revetment units (steps).



Facilities at Thornton

Piling work to the toe for the first phase is now complete. The piling rig is a hydraulic unit designed to reduce vibration and noise. It will be employed again on the next phase.

The revetment units are placed by a 135 tonne crane and lifted by a hydraulic suction lifter. This avoids lifting straps or holes in the revetment.

Earth Moving and Recycling

In order to construct the defences it has been necessary to move large quantities of beach material. This material has been pushed out of the construction area but returns quickly. The completed sections of piling and bottom revetment have now been buried by the beach materials.



Unit being lifted into place.



Recycling Demolition Material.

Large parts of the existing defences have been demolished. All material has been recycled; much of it has been crushed and incorporated within the new works.

The contractor, Birse Civils Ltd, is operating as a registered 'Considerate Constructor'. This means that the scheme aims to improve the image of the construction industry by encouraging good communication with site neighbours and the general public. As associate members of the scheme, Birse Civils Ltd actively work to improve their performance and this is evident by the outstanding results achieved in the recent audit at the Cleveleys site. Examples of 'Best Practice' and 'Public Relations' have contributed to its ongoing success.

Café Building

The existing promenade facilities such as the Ice Cream bar, toilet facilities and beach patrol accommodation are to be housed in a new architecturally designed modern building. This will include a café with outdoor seating and a water play area, to be located at the Carr Gate end of the scheme.

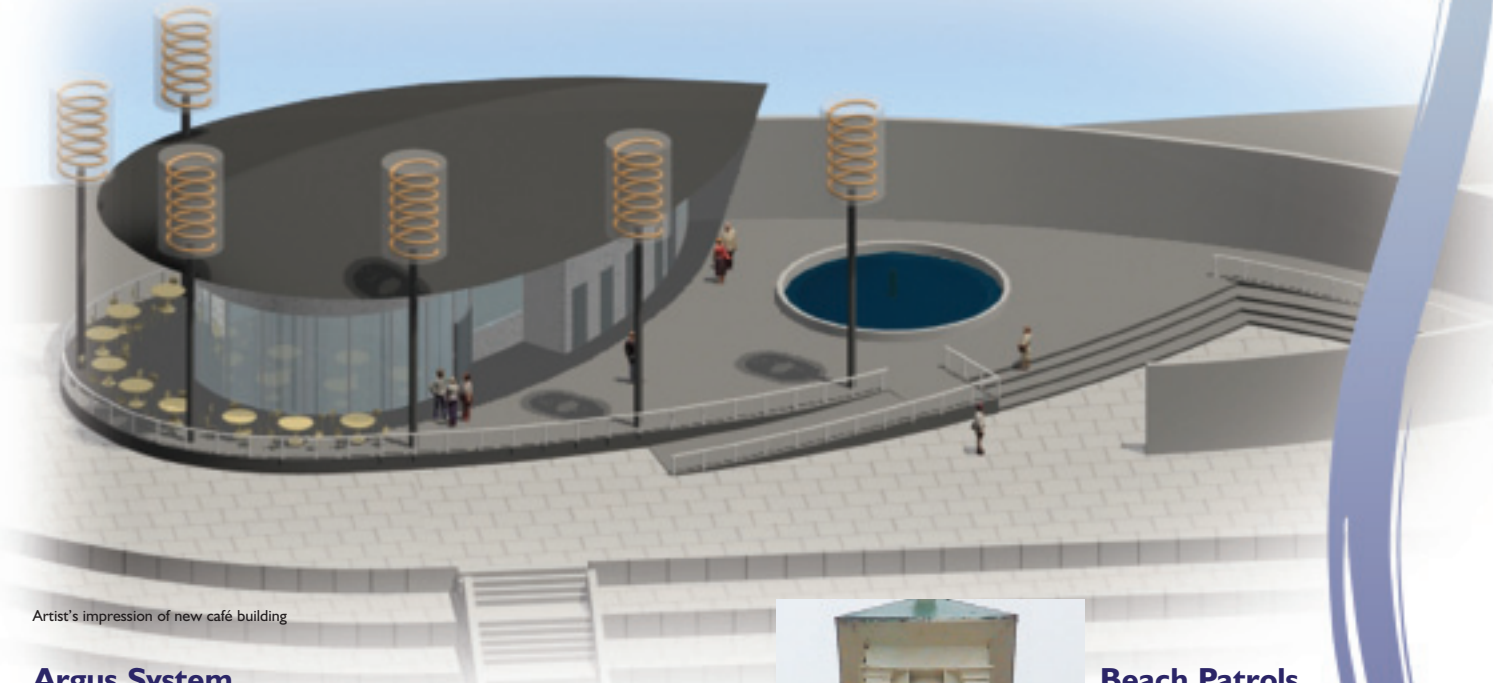

Artist's impression of new café building

Argus System

Cleveleys has joined an exclusive club of coastal authorities, including Bondi beach and California, in monitoring the beach using the Argus camera system. Images of the beach and tide conditions are currently being received.

Lancaster University are working with us to monitor the impacts on the beach and the system also allows us to monitor any dangerous currents. It also helps us with the design process of future sea defence works.

Iconic Building

Expressions of interest from a number of developers have been received for the building to be located at the end of Victoria Road West. These are currently being assessed.

The existing children's amusement area at the end of Victoria Road West will be closed at the end of October 2006 to enable the next phase of construction works to commence. A site for a new children's amusement facility will be provided within the new scheme. Expressions of interest from potential operators will be sought very soon. It is anticipated that the new facility will be open for the 2008 season.



The Argus System

Beach Patrols and Safety

The lifeguard service is undergoing a radical change to improve public safety and management of the beach.

You will soon see the new-look patrols at Cleveleys.